

Mini-P^{MAX}

User manual

Battery and Charging

The MOZA Mini-P max has a built-in lithium battery. Fully charge the battery before first use. The LED power indicator blinks when the battery level is less than 20%. Charge it with an universal USB-C cable, Mini-P max can be charged through a phone charger and mobile power supplier. The charging stops automatically when the battery is fully charged.

Notes:

1. Please do not over-charge or over-discharge the battery. Otherwise the battery will be damaged.
2. Recharge and discharge the battery every 3 months to keep it intact if it is left unused for a long time.

认识Mini-P max

- 1 Tilt Arm
- 2 Pan Knob
- 3 Pan Storage Lock
- 4 Slide Lock
- 5 Power Button
- 6 USB-C Charging Port
- 7 Reset hole
- 8 1/4" Port
- 9 Tilt Storage Lock
- 10 Roll Motor
- 11 Roll Storage Lock
- 12 Pan Arm
- 13 Joystick
- 14 Operation Button
- 15 Battery Level Indicator

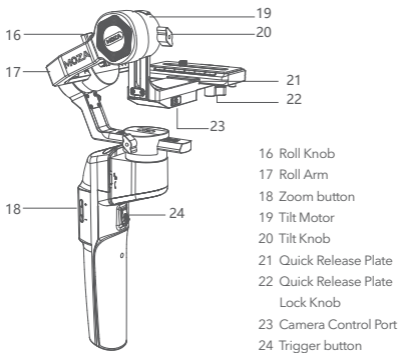
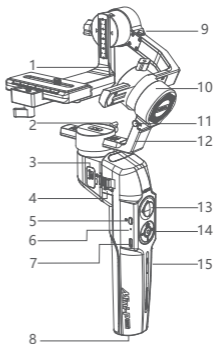

Store and Expand the Mini-P Max

Mini-P Max is equipped with a three-axes storage lock for gimbal storage and leveling.

1. Unlock the pan storage lock, roll storage lock and tilt storage lock to turn on the three-axes motor.
2. Rotate the pan arm 90° clockwise, and then lock the pan storage lock (from a top view)

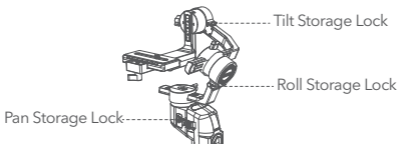

3. Rotate the roll arm 90° counterclockwise, and then lock the roll storage lock (from a front view)

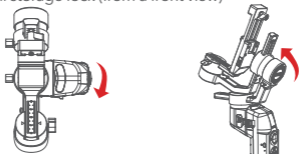

Mounting and Balancing the Camera

• Tilt Axis Leveling

1. Place the longer side of the quick release plate under the camera, and secure the camera with a 1/4" screw.
2. Loosen the quick release plate lock knob, slider the shorter side of the quick release plate into center of the quick-release base, then lock the knob.
3. Fine-tune the quick-release plate back and forth until the lens is horizontally forward, then lock the knob.

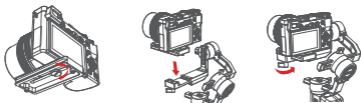

4. (From a left view,) Rotate the tilt arm 90° clockwise, loosen the tilt knob, adjust the tilt arm left and right until the lens is straight up (leveled), then lock the knob.

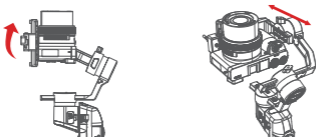

Note: How to judge whether the tilt axis is leveled?
Answer: Once the tilt axis is leveled, the lens can maintain balance and stability at any angle

• **Roll Axis Leveling**

5. (From a front view,) Unlock the roll storage lock, loosen roll lock, adjust the roll arm left and right until it is balanced horizontally, and then lock the knob.



Note: How to adjust the arm smoothly
Answer: For precise adjustment, it's recommended to keep the arm with your hand when leveling.

• **Pan Axis Leveling**

6. Unlock the pan storage lock, loosen pan lock, rotate the pan arm 90° clockwise, adjust the pan arm left and right until it is balanced horizontally, and then lock the knob.

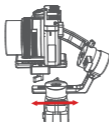

Button Features

Simplified Operation

Down Button

- Double press: Sports gear mode, double press again to exit sports gear mode
- Triple press: Inception mode, Triple press again to exit inception mode



Joystick

- Move upwards: phone camera turns up
 - Move downwards: phone camera turns down
 - Move leftwards: phone camera turns left
 - Move rightwards: phone camera turns right
- The speed of camera moving increases with the larger moving range of joystick



Follow Function

- Left Button
Press twice the left button: FPV mode.
Press twice again to stop



Check the Battery Level

Status Indicator

- Blue light is always on: 60%-100% battery level
- Blue light flashes slowly: 20%-60% battery level
- Blue light flashes quickly: 0%-20% battery level
- Orange light flashes slowly: Gimbal motor enters to sleep mode
- Blue and orange lights flash quickly: FPV mode
- Blue and orange lights flash slowly in turn: Firmware upgrade mode
- The red light is always on: Charging
- The red light is off: Charging Completed



Trigger

- Double press: Re-center
- Single press: Auto focus (some cameras are not supported)
- Triple press: Switch to selfie mode
- Hold: Switch to tilt follow mode
- Double press and hold: Switch to All-locked mode



Zoom Button

Triple press + button: Auto tune



Button

Press once : Sleep mode

Long press: Turn on / off



Product Specification

Specs	
Payload	130g~900g / 0.29lbs~1.98lbs
Weight	710g/1.565lbs
Dimensions (mm)	Gimbal (unfolded): 305*51*166
	Gimbal (folded): 198*166*102
Supported Phone Size	58 ~ 88mm
Battery Life	20 (h)
Battery Specs	Standard Voltage: 7.4 V
	Battery capacity: 2000 mAh
Charging Time	3 (h)
Mechanical Endpoint Range	Pan: 360°
	Roll: 330°
	Tilt: 330°

电池及充电说明

Mini-P max 使用内置锂电池，首次使用前，请先给Mini-P max充满电以激活电池，保证产品顺利使用。电量指示灯开始闪烁时，说明电量不足20%，请及时充电，Mini-P max使用通用Type-C接口，手机充电器、移动电源等都可以给Mini-P max充电。电池在充满时将自动停止充电，请断开充电器。

注意：

1. 切勿过充、过放电池，否则将对电芯造成损害
2. 若长期闲置电池，请每隔3个月左右重新充电一次以保持电池活性

认识Mini-P max

- 1 俯仰臂
- 2 航电臂锁紧旋钮
- 3 航向机械锁
- 4 锁滑扣
- 5 电源开关
- 6 充电USB口
- 7 复位孔
- 8 1/4 螺丝孔
- 9 俯仰机械锁
- 10 横滚电机
- 11 横滚机械锁
- 12 航向臂
- 13 摇杆
- 14 操作按键
- 15 电量指示灯

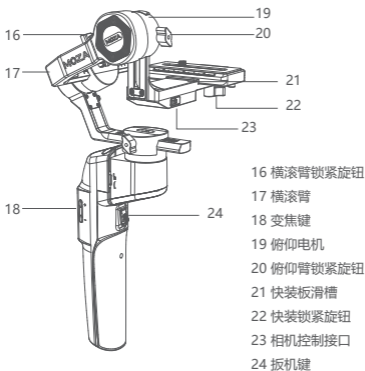
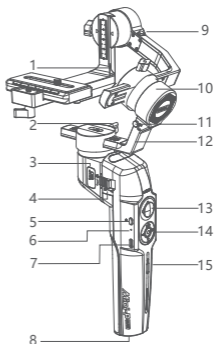

云台的收纳与展开

Mini-P max配备了三轴电机锁，助于云台部分的收纳，调平

1.分别打开航向电机锁、横滚电机锁、俯仰电机锁，即可解锁三轴电机

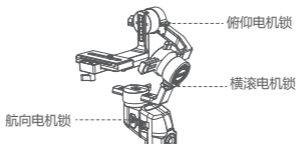

2.将航向臂顺时针转动90°，然后关闭航向电机锁（俯视角下）

3.将横滚臂逆时针转动90°，然后关闭横滚电机锁（正视角下）

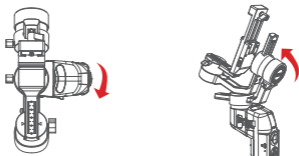

相机的安装

• 俯仰轴调平

1. 将阿卡快装板的锁紧螺丝置于相机底部1/4螺丝孔，用手拧螺丝锁紧相机（也可工具协助）
2. 顺时针旋转松开快装锁紧旋钮，将快装板嵌入在滑槽内
3. 前后微调快装板，直到保证镜头相机水平平衡稳定后，逆时针旋转锁紧快装锁紧旋钮

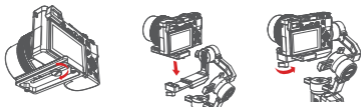

4. (左视角度下) 将俯仰臂顺时针旋转90°，松开俯仰电机锁紧螺丝俯仰臂锁紧旋钮，左右调节俯仰臂，直到保证镜头竖直朝上稳定平衡时，锁紧俯仰臂锁紧旋钮即可

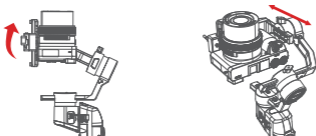

注意：如何判断俯仰轴是否调平？

解答：调平后，转动俯仰轴电机，相机镜头可以在任意角度下保持平衡稳定

• 横滚轴调平

5. (正视角度下) 打开横滚电机锁，松开横滚臂锁紧旋钮，左右移动横滚臂，直到横滚臂能水平保持平衡，即可锁紧横滚臂锁紧旋钮

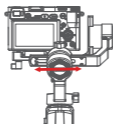

注意：如何顺畅的调节臂

解答：调平时，建议一只手托着臂，这样比较利于精确调节

• 航向轴调平

6. 打开航向电机锁，旋松航向臂锁紧旋钮，将航向臂旋转90°，水平左右调节航向臂，直到航向臂可以水平保持平衡，即可旋紧航向臂锁紧旋钮

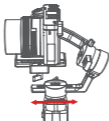

按键操作

快速动作

操作按键下键

- 双击：极速跟随，再次双击退出极速跟随
- 三击：盗梦空间，再次三击退出盗梦空间



摇杆使用

- 向上拨：手机镜头向上转
 - 向下拨：手机镜头向下转
 - 向左拨：手机镜头向左转
 - 向右拨：手机镜头向右转
- 拨动的幅度越大转速越快



跟随功能

- 操作按键左键

双击左键打开FPV模式，再次双击关闭。



电量查看

状态指示灯

- 蓝灯常亮：电量60%--100%
- 蓝灯慢闪：电量20%--60%
- 蓝灯快闪：电量0%--20%
- 橙灯慢闪：稳定器电机休眠
- 蓝灯和橙灯快闪：FPV模式
- 蓝灯和橙灯轮流慢闪：升级模式
- 红灯常亮：充电中
- 红灯熄灭：充电完成



扳机键

- 双击：归中
- 单击：自动对焦（部分相机不支持）
- 三击：切换至自拍模式
- 按住：切换至俯仰跟随
- 双击扳机键，第二次按住不松手：切换至全锁定



变焦键

三击+键：自动调整电机参数

电源键

单击：稳定器休眠/唤醒

长按：稳定器开机/关机



产品参数

云台规格	
载重	130g~900g
重量	710g
尺寸(mm)	展开尺寸：305*51*166(L*W*H)
	折叠尺寸：198*166*102
支持手机尺寸	58 ~ 88 mm
电池续航时间	20 (h)
电池规格	标准电压：7.4 V
	电池容量：2000 mAh
充电时间	3 (h)
机械角	航向：360°
	横滚：330°
	俯仰：330°

产品保修卡

产品型号		购买日期	
姓名		电话	
地址			

经销商信息（签章）

产品保修条例

保修期

自购机日起，云台主体保修12个月；云台电机、智能电池保修3个月。设备外壳、说明书、USB线材、包装等不在“一年免费保修服务”范围内，您可以选择有偿服务。

七日内免费退货

自购机日起7日内，根据国家最新三包规定，您可以选择退货（按票面金额一次性退清货款）、换货（更换同型号同规格的产品）或修理。

八至十五日免费换货或修理

自购机日起第8日至第15日内，主机出现性能故障，并经特约维修中心检测，确认非人为损坏的本身质量问题，您可以选择换货（更换同型号、同规格产品）或修理；但是更换的范围，只限于产品主机，其他配件无质量问题，不能更换；购买者在以下条件下不享受免费保修服务，您可以选择有偿服务。

1. 超过三包有效期的；
2. 无三包凭证及有效发货票的，但能够证明该产品在三包有效期内的除外；
3. 包修凭证上的型号与修理产品型号不符或者涂改的；
4. 非本公司特约维修人员拆动造成损坏的；
5. 因不可抗力造成损坏的；
6. 未按产品使用说明书要求使用、维护、保养而造成损坏的。



GUDSEN
INVENTED FOR VIDEO
Shenzhen Gudsen Technology Co., Ltd
Web: www.gudsen.com