

English

PONS PT Motorized Pan Head

**PD-E1**

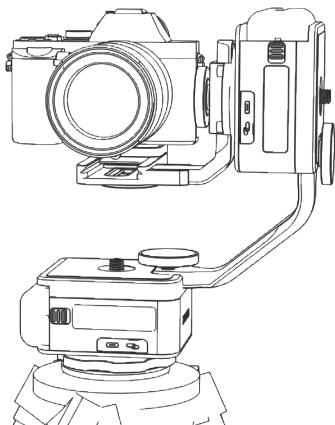

Operating Instruction

**Illustrate:1 PONS PT Motorized Pan Head is composed of 2 PONS Motorized Pan Head (PS-E1) and 1 PONS Tilt Arm Kit (AP-H1)**

## Instructions for Use

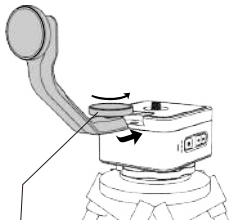

**1** Loosen the two-axis knob counterclockwise until the connecting arm can be smoothly inserted into the slot on the single axis. Do not insert the arm forcibly, or it will easily cause abrasion between the connecting arm and the single axis. Tighten the knob after the arm is clipped.

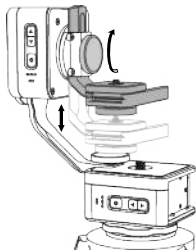

**2** Adjust the knob to move the connecting arm up and down according to the needs of shooting.

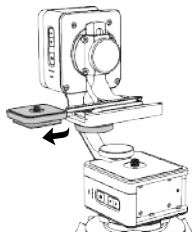

**3** Loosen the adjusting knob and take out the quick-mount plate.

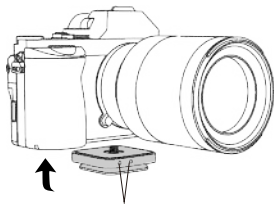

Note: the side with screw holes on the quick-mount plate always faces the lens.

**4** Install the quick-mount plate to the bottom of the camera.

## Instructions for Use

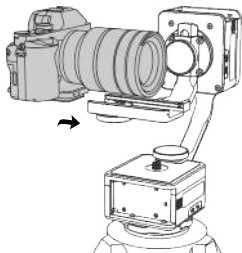

- 5** Install the camera with the quick-mount plate into the quick-mount plate mount.

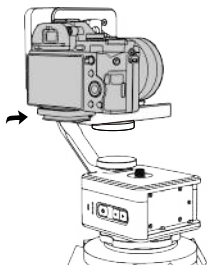

- 6** Once the camera is completely pushed into the quick-mount plate mount, you will hear a snap due to the magnetic force generated by the built-in magnet device, which indicates that the quick-mount plate has been completely fitted to the mount.

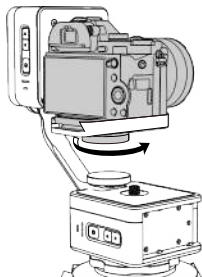

- 7** Tighten the top knob to fix the camera.

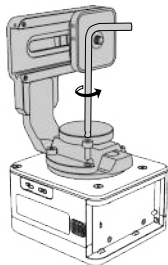

- After removing the connecting arm, you can use the PT head as two pan heads separately.

## Inception Mode

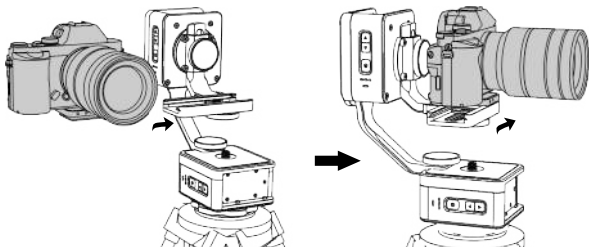

When shooting in the Inception mode, push the camera to the end of the quick-mount plate mount as shown in the figure, and tighten the top knob. After that, the camera is aligned with the Y axis, indicating that the axis of the camera and that of the uniaxial pan head are on the same line.

## Notes

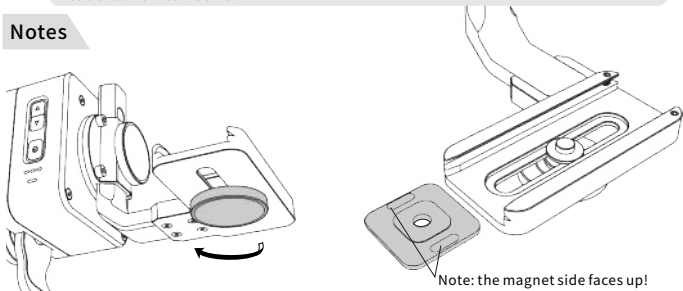

When the top knob is loosened clockwise to a certain extent, the top plate in the quick-mount plate mount is prone to fall out. If it falls out, just reinstall it.

---

## Important:

This device complies with Part 15 of the FCC Rules. Operation is subject to the following two conditions: (1) this device may not cause harmful interference, and (2) this device must accept any interference received, including interference that may cause undesired operation.

Changes or modifications to this unit not expressly approved by the party responsible for compliance could void the user's authority to operate the equipment.

NOTE: This equipment has been tested and found to comply with the limits for a Class B digital device, pursuant to Part 15 of the FCC Rules. These limits are designed to provide reasonable protection against harmful interference in a residential installation. This equipment generates, uses and can radiate radio frequency energy and, if not installed and used in accordance with the instructions, may cause harmful interference to radio communications. However, there is no guarantee that interference will not occur in a particular installation. If this equipment does cause harmful interference to radio or television reception, which can be determined by turning the equipment off and on, the user is encouraged to try to correct the interference by one or more of the following measures:

- Reorient or relocate the receiving antenna.
- Increase the separation between the equipment and receiver.
- Connect the equipment into an outlet on a circuit different from that to which the receiver is connected.
- Consult the dealer or an experienced radio/TV technician for help.

This device and its antenna(s) must not be co-located or operation in conjunction with any other antenna or transmitter.

### Radiation Exposure Statement

The device has been evaluated to meet general RF exposure requirement. in portable exposure condition without restriction.