

ATOM

Quick Start Guide
快速入门指南

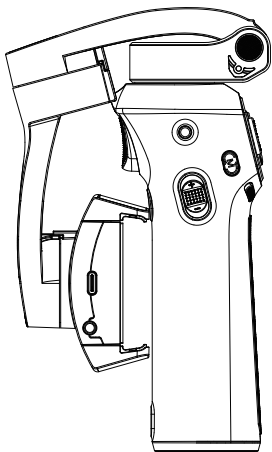

1. Introduction

ATOM is a foldable three-axis phone gimbal, featuring portable, lightweight, wired and wireless phone charging, integrated microphone jack, one-key orientation switch, high payload, long runtime and so on, which can provide you with brilliant phone filming experience.

Structural diagram:

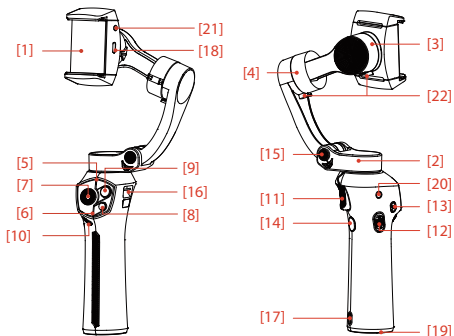

[1] Phone holder

[2] Pan motor

[3] Roll motor

[4] Tilt motor

[5] Mode indicator

[6] Battery indicator

[7] Joystick

[8] Shutter/record key

[9] Menu key

[10] Power

[11] Trigger button

[12] Zoom/Focus slide key

[13] Customizable M key

[14] Customizable back key

[15] Fold key

[16] Strap hole

[17] Gimbal charging port

[18] Phone charging port

[19] ¼ inch threaded hole

[20] Microphone jack

[21] Mic connection port

[22] Motor lock

2. In the Box

ATOM gimbal



Type-C to Type-C cable

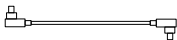

Type-C to Lightning cable

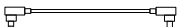

USB to Type-C gimbal charging cable



Mic jack cable



Carrying bag



Quick start guide



Warranty card



3. Opening and closing the ATOM

- Open:** ① press and hold the spring button ② to open the arm, ③ unlock the roll and tilt motors by turning the motor lock.

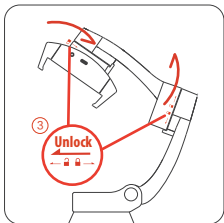
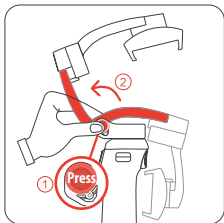

Notice: If either motor is locked when the gimbal power is on, the motor will beep for a while and the gimbal will enter standby mode. To start the gimbal normally, make sure to unlock the motors before startup.

- Close:** turn to lock the tilt and roll motor separately, press and hold the spring button and fold the arm.

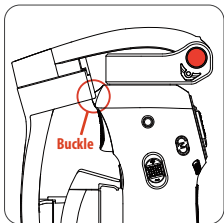
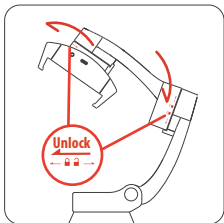

4. Mounting the phone

[1] Mount the phone into the phone holder in the middle position.

Notice: The gimbal will vibrate if the phone holder is empty. Make sure to mount the phone before starting up the gimbal.

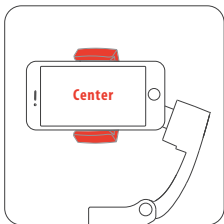
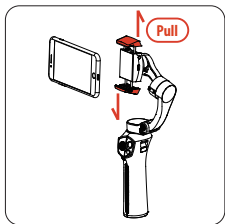

[2] Mount the phone with the camera on the left checking that the camera is not blocked. Make sure the back of the phone is flat and fits the phone holder well without a gap.

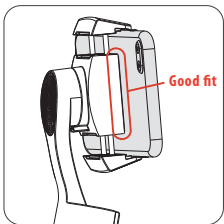
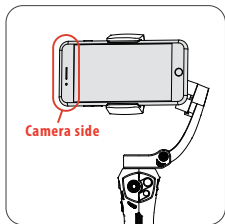

[3] When mounting an add-on lens, move the phone to the right to make the center of gravity align with the center of the phone holder.

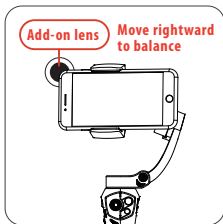

5. Power on/off

On: Move the power key up to turn on the gimbal, and the power indicator becomes constant green. If the power indicator shows red, it means the gimbal battery is low and needs to be charged.

Off: Move the power key up and hold for 2 seconds until the power indicator goes off.

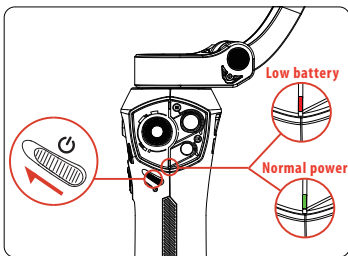

6. Download the Snoppa App

Please scan the barcode bellow, or search for "Snoppa" in the App store for iOS or Google Play for Android.

iOS system:



Android system:



Notice: Snoppa App only support IOS 8.0 or later, and Android 6.0 or later.

7. Bluetooth connection

- [1] Make sure the Bluetooth in the phone is turned on.
- [2] In the Snoppa app, press the Bluetooth icon on the corner. In the popup menu choose the ATOM device to connect and pair. (You can also connect the ATOM Bluetooth in the phone system setting panel directly, in order to use the phone camera app or other filming app)

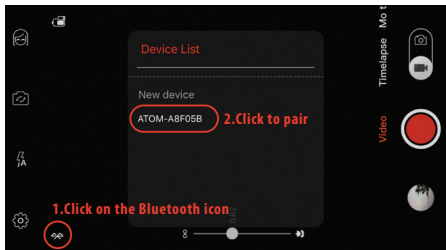

Notice: The ATOM will automatically connect to the last phone paired by Bluetooth. So when connecting to other unpaired phones, please make sure the Bluetooth is disconnected with the last phone. You can press the menu button for five times to clear the former Bluetooth connection record and reconnect the new Bluetooth device again.

8. Firmware update

To update the gimbal when there're new functions, you will need to update the gimbal's firmware. In order to get the best experience, please keep the firmware updated.

The firmware is checked, detected and updated in Snoppa app setting menu.

Notice:

- During the updating process, the mode indicator will flash blue until the update finishes. Don't lock the screen or switch the Snoppa app to background in this case the updating is interrupted.
- Keep the phone and the ATOM placed together, if they are separated the Bluetooth would be disconnected and the update may fail.
- If the update is interrupted, just update it again.

9. Gimbal calibration

The gyro sensor would be affected by environmental variations. When the surrounding temperature changes or after transporting it for a long distance, the gimbal may drift automatically or go out of level when starting up, which is a normal phenomenon and can be fixed by performing calibration in the app.

[1] Connect the phone to the ATOM by Bluetooth.

[2] In the Snoppa App, find the calibration buttons in the setting-gimbal panel. First perform the "Drift calibration", and then do the "Level calibration".

Notice: Keep the gimbal still during the drift calibration, otherwise it may affect the calibration result.

10. Customizable key

The customizable keys can be defined in the Snoppa App setting menu. Setting—Gimbal—Customizable button

Camera	Gimbal	General
Back key Long-press	< Scenarios >	
Back key Short-press	< Switch camera >	
M key Long-press	< Turn 180° >	
M key Short-press	< Orientation switch >	

Customizable key list:

- Customizable back key——Long press
- Customizable back key ——press
- Customizable M key——Long press
- Customizable M key ——press

Customizable key options :

- Follow modes switch
- Orientation switch
- Wireless charge
- Turn 180°
- Switch camera
- Parameters
- Scenarios

11. Phone charging

Wireless charge

ATOM can charge the phone wirelessly if the phone has wireless charging capability. “wireless charge” can be assigned to a customizable key, and you can use the key to enable or disable the wireless charge function.

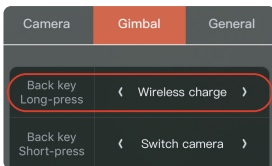

Charge by cable

Through the ATOM's phone holder, the phone can also be charged by cable. The ATOM package includes a Type-C to Type-C and a Type-C to Lightning charging cables.

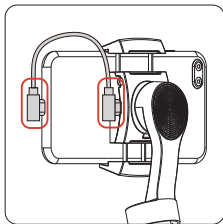

12. Control the original phone camera app

The ATOM uses Bluetooth to connect the phone system. When using the original phone camera app or other third-party filming apps, it is also possible to control the shooting with handle buttons.

Notice: one of the Android phones may not be controlled by ATOM.

13. Photo/video

Press the Shutter/video button to start or stop video recording or shutter when the ATOM is connected with the phone by Bluetooth.

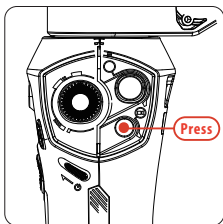

14. Follow modes

[1] "Follow modes" can be assigned to the customizable key, and you can switch "pan follow" and "omni-directional follow" by the key.

Customizable key

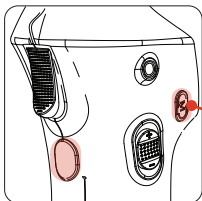

APP button custom interface

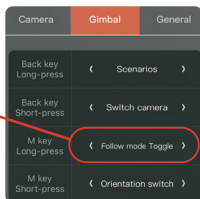

[2] The above indicator on the handle panel shows the mode you are filming in. The green light shows the ATOM is in omni-direction follow mode, and the gimbal will follow the arm's movement moving up and down or left and right. The blue light shows the ATOM is in pan follow mode and the gimbal will only follow your arm's movement moving left and right, and the tilt is locked.

Omni-direction follow mode

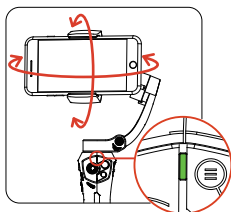

Pan follow mode

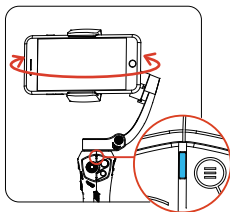

15.Horizontal/Vertical orientation switch

Orientation can be switched between horizontal and vertical by two methods:

Manual rotate :

Hold the phone with your hand and rotate it 90 degrees.

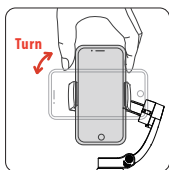

Button rotation : Set a customizable key with "orientation switch" function, and switch the orientation with the key.

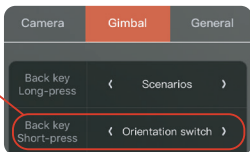
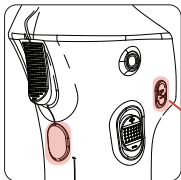

16. Quick follow mode

Press, press again and hold the trigger button, the gimbal will turn to quick follow mode. In the quick follow mode, the gimbal will move fast responding to arm's movement, which is better for tracking fast moving object.

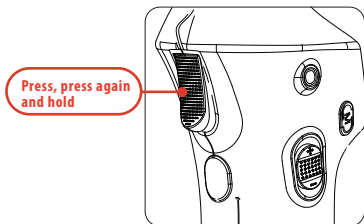

17. Direction lock

Press the trigger button and hold, the gimbal's direction will be locked. When the trigger button is released, the gimbal will return to the normal following mode.

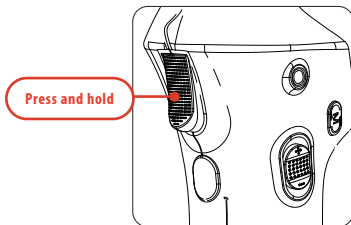

18. Manual focus and zoom

- [1] Connect the Snoppa app to the ATOM by Bluetooth.
- [2] In the gimbal setting, assign the slide key to "Adjust focus" or "zoom".
- [3] Now the phone camera focus or zoom can be controlled with the slide key.

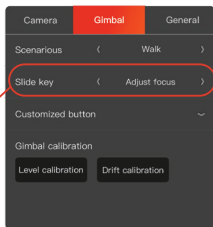
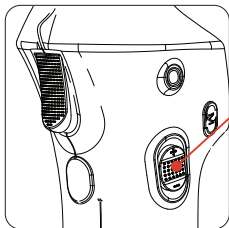

19. Function menu

When the ATOM is connected with the Snoppa app, the function menu can be called up by clicking the menu key on the handle. Call up the menu ①, choose different video modes or photo modes by moving the joystick ②.

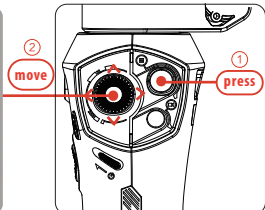
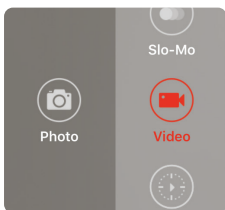

20. Specifications

Gimbal

Product name	ATOM
Working voltage	7.4V
Working current	90mA (in balance status)
Working temperature	-10℃~45℃
Dimensions (W*D*H)	Unfolded: 123*73*297(mm) Folded: 50*106*178(mm)
Body weight	440g
Tilt axis mechanical rotation range	330°
Roll axis mechanical rotation range	330°
Pan axis mechanical rotation range	360° (free rotation)
Static attitude tracking Error	±0.05
Motion attitude tracking error	±0.2
Mobile phone width range	55-90mm
Mobile phone thickness range	≤9mm
Max payload	310g
Microphone jack type	3.5mm TRRS

Battery

Type	Li-ion
Model	SP26350
Energy	14.8Wh
Capacity	2000mAh
Charging temperature	5-40℃
Charging time	3 hours (charging power-10w)
Runtime	24 hours