

Microphone G1A1 Pro >>> User Manual

Thank you for choosing SYNCO product. Please read this manual carefully before use and follow all instructions mentioned herein.

### Caring For Your SYNCO Product

- Please keep the product in a dry, clean, dust-free environment.
- Keep corrosive chemicals, liquids and heat source away from the product to prevent mechanics damage.
- Use only a soft and dry cloth for cleaning the product.
- Malfunction may be caused by dropping, impact of external force.
- Do not attempt to disassemble the product. Doing so voids warranty.
- Please have the product checked or repaired by authorized technicians if any malfunctions happened.
- Failure to follow all the instructions may result in mechanics damage.
- Warranty does not apply to human errors.

### Package List

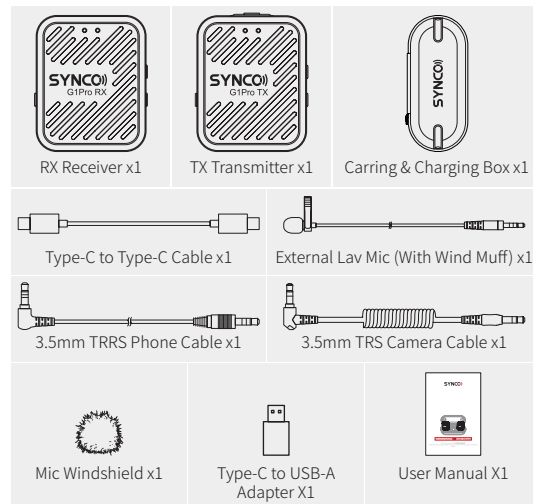

### Product Instruction

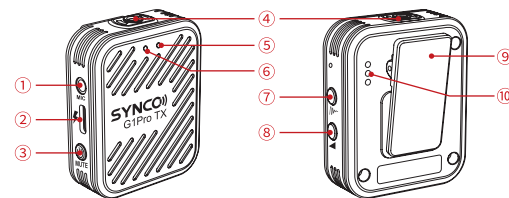

TX Transmitter

- |                        |                         |
|------------------------|-------------------------|
| ① External Mic Input   | ⑥ Pairing Indicator     |
| ② Type-C Charging Port | ⑦ Noise Reduction       |
| ③ On/ Off Button       | ⑧ Gain Adjustment of TX |
| ④ Built-in Mic         | ⑨ Magnet Pocket Clip    |
| ⑤ Power Indicator      | ⑩ Contacts              |

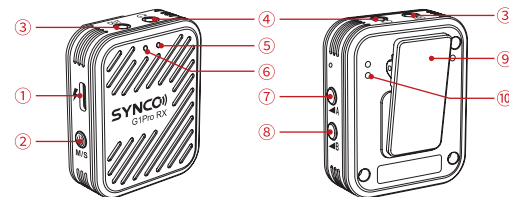

RX Receiver

- |  |                           |
|--|---------------------------|
| ① Type-C Charging Port / Digital Output              | ⑤ Power Indicator         |
| ② On/ Off Button (Mono / Stereo / Protected Channel) | ⑥ Pairing Indicator       |
| ③ 3.5mm TRS Output                                   | ⑦ Gain Adjustment of TX A |
| ④ 3.5mm Monitoring Port                              | ⑧ Gain Adjustment of TX B |
|  | ⑨ Magnet Pocket Clip      |
|  | ⑩ Contacts                |

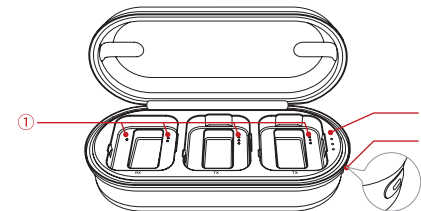

Carrying & Charging Case

- |            |                   |               |
|------------|-------------------|---------------|
| ① Contacts | ② Power Indicator | ③ Type-C Port |
|------------|-------------------|---------------|

### Indicator - TX

Pairing Indicator	● Blue Slow Flashes	Unpaired
	● Blue Keeps on	Paired (with Mute & Noise Reduction off)
Power Indicator	● Red Keeps on	Mute on
	● Blue & Red Both on	Noise Reduction on
Power Indicator	● Green Keeps on	Charging (Turns off when fully charged)
	● Green Flashes	Warning of low battery

### Indicator - RX

Pairing Indicator	● Blue Slow Flashes	Unpaired
	● Blue Keeps on	Paired (Mono Channel)
Power Indicator	● Red Keeps on	Stereo Mode
	● Blue & Red Both on	Protection Channel Mode (R channel with less than 6dB)
Power Indicator	● Green Keeps on	Charging (Turns off when fully charged)
	● Green Flashes	Low Battery

### Operations

#### 1. Power On/ Off

##### Power On

Method 1: The TX and RX automatically turn on after taken out from the charging Case.

Method 2: The TX and RX automatically turn on when long press the power button for 3 seconds, and the blue status indicator light up.

##### Power Off

Method 1: After put the transmitter/receiver into the charging case, the green indicator light keeps on for automatic charging. After being fully charged, the green indicator light will turn off and automatically shut down.

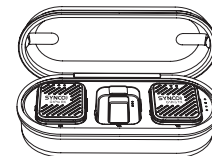

Method 2: The TX and RX automatically turn off when long press the power button for 3 seconds, and the red status indicator light off.

#### 2. Pairing

##### Automatic Pairing

Automatically pairing after the TX/RX turns on when taken out from the charging case.

##### Manual Pairing

(1) Long press the power button for 8 seconds while the TX is powered off until the blue pairing indicator flashes.

(2) Long press the power button for 8 seconds while the RX is powered off until the blue /red/ green pairing indicators flashes.

(3) The blue light keeps on when the TX successfully paired. (And the red, green and blue pairing indicators on the RX flash for about 1 minute, and the blue light keeps on when exit the pairing state).

#### 3.Connection

The receiver outputs the audio signal to the recording device via either a 3.5mm TRRS Phone Cable or a 3.5mm TRS camera cable. Use the

appropriate cable according to your device.

(Note: When using an external microphone, please insert it correctly into the microphone input port.)

#### 4. Volume Control

① Press the power button on the TX to turn on/off the mute. When mute is on, the red pairing indicator on the TX keeps on.

② Short press the gain adjustment button of the TX to adjust the volume for 4 levels.

③ Short press the gain adjustment of A/B TX buttons on the RX to adjust the volume of A/B TX.

#### 5. Noise Reduction

Short press the noise reduction button on the TX to turn on/off the noise reduction function. When the noise reduction on, the red and blue indicator light on the TX status light up at the same time.

#### 6. Switch the Channel Mode

Short press the power button on the RX to switch the mono/stereo/protected channel mode.

Default mono mode. When switching to stereo mode, the red pairing indicator light keeps on. When switching the protection channel mode, the blue&red pairing indicator lights light on at the same time.

#### 7. Charging

① Connect the charging cable through the Type-C port to charge the charging case, and fully charged about 3.5 hours.

② The TX/RX: Automatically charge through the contact point of the charging case after put into the charging case.

③ Connect the charging cable through the Type-C port of the receiver and the transmitter, and fully charged in about 2 hours.

Specifications	
<b>TX Transmitter</b>	
Wireless Transmission	Digital 2.4GHz
RF Frequency Band	2400-2483.5MHz
Working Distance	656ft/200m (LOS area), 164ft/50m (NLOS area)
Mounting	Pocket Clip
Audio Input	3.5 mm TRS Mic Input
Power Requirements	5V 1A
Battery Type	Built-in Lithium Battery, 400mAh
Battery Charging Time	2H
Battery Life	8H
Dimensions	52*42*16mm
Material	ABS
Weight	35g

<b>RX Receiver</b>	
Wireless Transmission	Digital 2.4GHz
RF Frequency Band	2400-2483.5MHz
Working Distance	656ft/200m (LOS area), 164ft/50m (NLOS area)
Latency	20ms
Mounting	Pocket Clip
Number of Audio Channels	2
Audio Output	3.5 mm TRS Mic Output 3.5 mm TRS Headphone Output Type-C Output
Gain	1~30dB

Power Requirements	5V 1A
Battery Type	Built-in Lithium Battery, 400mAh
Battery Charging Time	2H
Battery Life	8H
Dimensions	52*42*16mm
Material	ABS
Weight	35g

#### Microphone

Form Factor	Built-in/External Mic
Polar Pattern	Omnidirectional
Frequency Range	50Hz-20KHz
Sensitivity	-40dB ( $\pm 3$ dB, re 1V/Pa at 1KHz)
Maximum SPL	120dB SPL (at 1KHz)

#### Charging Case

Battery Type	3400mAh
Battery Charging Time	3.5H
Charging Port	Type-C
Power Requirement	5V 1A
Dimension	176*80*53mm
Weight	227g

## Warranty

#### Warranty Period

Thank you for purchasing SYNCO products.

1. Customers are entitled to free replacement or repair service in case of quality defect(s) found in the product under normal use within 30 days upon receipt of the product.

2. Original SYNCO products are entitled to **12-month** limited warranty service. The warranty period begins on the date of purchase of brand new, unused products by the first end-user.

Within the warranty period, if product defect or failure is attributable to material deflection or technological problem, the defective product or defective part will be repaired or replaced without charge (service and materials fee).

#### Warranty Exclusions and Limitations

- Faults resulted from inappropriate use of a product without following its operation specification
- Artificial damage, e.g. crash, squeeze, scratch, or soaking
- Modifications to a product by its user or a third party without prior written consent of SYNCO, e.g. replacement of element or circuit, label alteration
- The code on product is inconsistent with that of warranty certificate, or the code on the product or warranty certificate is altered or torn off
- All consumable accessory attached to a product, like cable, wind muff, battery
- Faults as a result of force majeure, such as fire, flood, lightning, etc.

#### Warranty Claim Procedure

● If failure or any problem occurs to your product after purchase, please contact a local agent for assistance, or you can always contact SYNCO's customer service through email at [support@syncoaudio.com](mailto:support@syncoaudio.com).

● Please retain your sales receipt and warranty certificate as proof of purchase. If any of these documents is missing, only sales return or chargeable service will be provided.

● If the SYNCO product is out of the warranty coverage, the service and the parts cost will be charged.

WARRANTY CERTIFICATE	
Please register your warranty. Meanwhile, you are welcomed to contact us via Email: <a href="mailto:support@syncoaudio.com">support@syncoaudio.com</a>	
USER INFORMATION	Customer Name:
	Phone Number:
	Email:
	Address:
SALES INFORMATION	Sales Date:
	Model:
	Product Code:
	Dealer:
REPAIR RECORD	Service Date:
	Technician:
	Issue:

RESULT  Solved  Unsolved  Returned(Replaced)

#### Guangzhou Zhiying Technology Co., Ltd

Room 2401, 24 / F, South Tower, Lisheng Plaza, No. 68 Huadi Avenue, Liwan District, Guangzhou, China, 510000

[support@syncoaudio.com](mailto:support@syncoaudio.com)

[www.syncoaudio.com](http://www.syncoaudio.com)

<https://www.facebook.com/syncomicrophones>